

KEY FIGURES: EPICO AT THE PALACE OF QUELUZ, PORTUGAL NOVEMBER 2019

HISTORY:

One of the most remarkable examples of the harmonious link between landscape and palatial architecture in Portugal, the National Palace of Queluz and its gardens illustrate the environment and lifestyle which the Royal Family and the Portuguese Court enjoyed in the second half of the 18th century and early 19th century.

In 1654 King João IV established the House of Princes, which included the Country House of Queluz, formerly the property of the Marquis of Castelo Rodrigo. From 1747 on, the future King Consort Pedro III devoted his attention to the expansion of the palace giving it the dimensions of a genuine Royal Palace. It becomes the royal family's preferred place for their leisure and entertainment. It was their permanent residence from 1794 until their departure for Brazil in 1807, due to the French invasions.

In 1910, after the proclamation of the Portuguese Republic, the Palace of Queluz was designated a National Monument.

On the night of October 4th 1934, there was a fire that mainly damaged the Robillion Pavilion and Ambassadors Room. In 1940, following a series of restoration projects, the Palace reopened to the public.

Since 2012 Parques de Sintra Monte da Lua has been responsible for the management of the Palace. The National Palace of Queluz is a member of the Network of European Royal Residences and has been since 2013.



SCHEDULE:

Assessment steps	Time needed
Preparing condition report tools 1 person	5 days
Zoning and sampling 2 people	2 days
Collect data 8 people	3 days
Data treatment 2 people	2 days
Results and recommendations 8 people	2 days
Total for 41 rooms	14 days

RESULTS :

- **1492** Total number of inventoried works → **63** objects in the EPICO sample
- **41** Rooms → **21** Zones
- **464** damage causes founded.

- **4 major causes identified:** Dust, Inherent degradation-climate, Physical forces, Pests

- **1 major risk** for the collection : Dissociation

- **4 actions could improve** the conditions of conservation of 80% of the objects affected by the causes mentioned above.

TYPOLOGY	NB ITEM IN THE SAMPLE
FOURNITURE	18
PAINTING	2
GRAPHIC ART	7
SCULPTURE	1
ART OBJECT	26
DECOR	9
Total	63

RANKING: alteration cause impact (objects affected by causes + scale of damage):

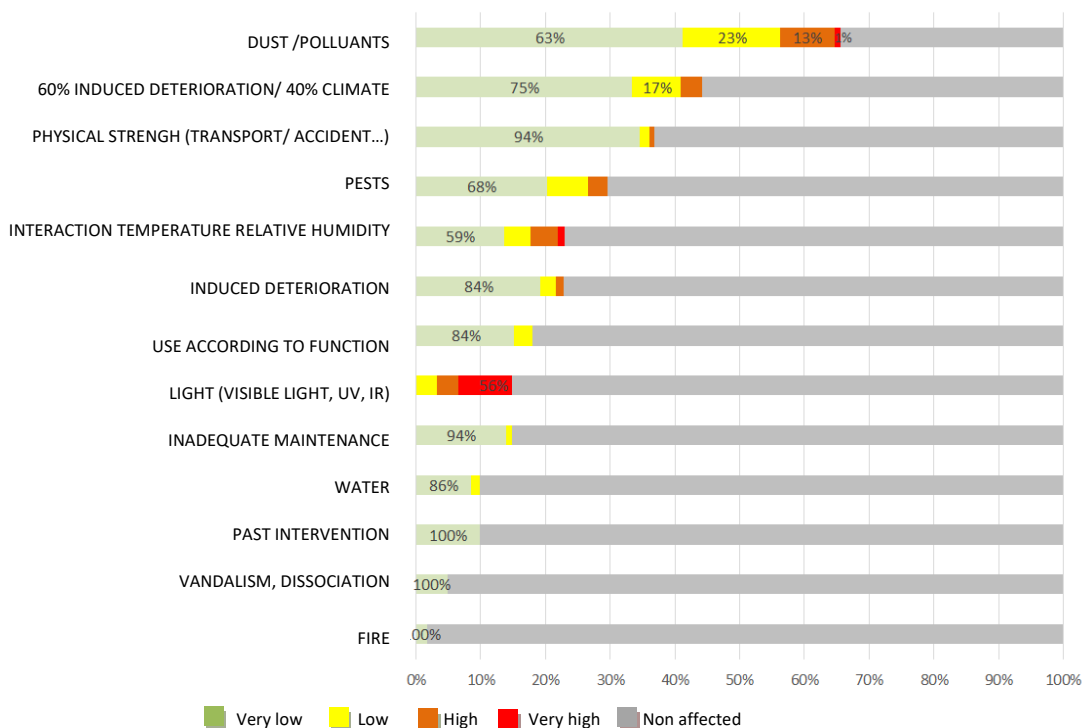

MULTICRITERIA ZONING:

Zoning makes it possible to group rooms with similar characteristics (museography, type of visit, activities, human impact and orientation) where we could have similar impact on the collection.

ZONE	ROOM	N°
2	SALLE D'EMANGUE	26
2	SALLE DU ARCHER	29
3	SALLE DU CONSEIL	32
3	CHAMBRE DON QUICHOTTE	36
4	SALLE À MANGER	22
4	BIBLIOTHEQUE D'ART ÉQUESTRE	40
11	SALLE DE CHASSE	5
11	SUITE DE SALON DE D.MARIA FRANCISCA BENEDITA	13
11	CHAMBRE MARIA FRANCISCA	14
11	CHAMBRE STYLE IMPÉRIAL	15
11	SALLE DE SCULPTURE	18
11	SALLE DU CONTADOR	19
11	RUMOIR	20
11	SALLE DE TORCHE	27
11	SALLE DUS PARTICULARES	30
12	CHAPELLE	11
12	SALLE DE AÇAFATAS	33
13	SALLE POMPÉIEN	6
13	SALLE DONA MARIA	7
13	ANTI-CHAMBRE DA SALLE DU TRÔNE	8
15	SALLE DE CAFÉ	21
17	SALLE LANTERNIM	12
19	SALLE D'ANGLE	25
29	ACCÈS AU PALAIS DE PRÉSIDENCE	3
30	SALLE GÔUTERS	34
30	SALLE VAREJONA	1
30	L'ORATOIRE DU ROI	35
31	GABINET DE TOILETTE	39
31	CHAMBRE DE LA REINE	38
31	ORATOIRE DE LA REINE	37
33	SALLE ROSE	2
36	ANTI CHAMBRE DA SALLE ROSE	4
38	SALLE DES ENBASSADEURS	31
49	SALLE DU TRÔNE	9
49	SALLE DE MUSIQUE	10
49	SALLE PASSAGE À JARDIN	24
78	VIEILLE ENTRÉE	41
146	CHAMBRE BERCEAU	16
151	CHAMBRE DE STYLE DOM JOSÉ	28
153	ORATOIRE DE PRINCESSES	17
264	SALLE DE PORCELAINE	23

- Museography
- Type of visit
- Orientation
- Human Impact
- Activities (event, shooting,...)

ZOONING

41 ROOMS → 21 ZONES

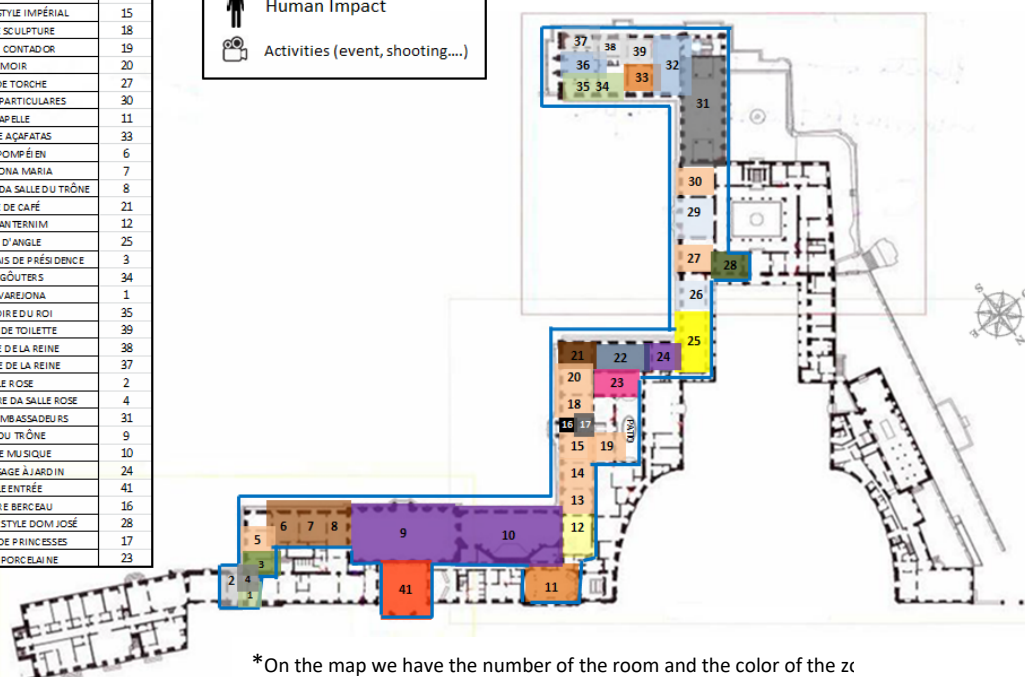

EPICO TEAM AT THE PALACE OF QUELUZ :

Daniel Fitzenreiter, Danilo Forleo, Joana Amaral, Nadia Francaviglia, Marta Jones, Nidia Miranda, Noémie Wansart and Valérieane Rozé